

For PE and PVC pipe

Serie FIX-U

To ensure correct operation, Fitting instructions must be respected.
 Test pressure = 1,25 x PS

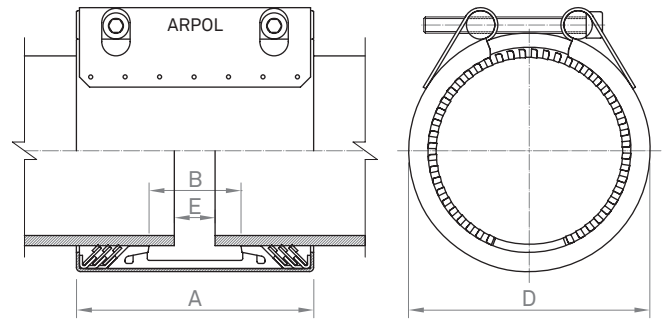

In order to prevent deformation and reduction of pipe diameters due temperature differentials, it is necessary to place an inner ring inside the PE or PVC pipe to stiffen it.

	Quality W1		Quality W2		Quality W4		Quality W5	
	AISI	DIN	AISI	DIN	AISI	DIN	AISI	DIN
Casing					304 L	1.4307	316 L	1.4404
Bolts					304	1.4301	316	1.4401
Bars					304 L	1.4307	316 L	1.4404
Inner Steel Plate (Lock)					304 L	1.4307	316 L	1.4404
Anchoring Ring					302	1.4310	316 L	1.4404

Sealing gasket: EPDM / NBR / Silicone azul

OD	Range	Pressure		ΔT max.			Max axial load			Dimensions				Bolts		
				°C			kN			A mm	B mm	D mm	E mm	Diam.	Tor. Nm	
				PS6	PS10	PS16	PS6	PS10	PS16							
63	62,0 - 64,0	10	16	40	30	7,5	9,5	99	31	85	5	M8	10			
75	74,0 - 76,0	10	16	40	30	10,6	13,5	117	31	97	5	M8	10			
90	89,0 - 91,0	10	16	40	30	15,2	19,4	117	31	112	5	M8	15			
110	108,0 - 111,0	10	16	40	30	22,7	29,0	117	45	132	5	M10	15			
125	123,0 - 126,0	10	16	40	30	29,4	37,5	118	45	149	5	M10	15			
140	138,0 - 142,0	10	16	40	30	36,9	47,0	118	45	164	5	M10	15			
160	158,0 - 162,0	10	16	40	30	48,1	61,4	118	45	184	5	M10	15			
180	178,0 - 182,0	6	10	16	40	20	15	40,6	43,3	51,5	201	95	217	10	M12	30
200	198,0 - 203,0	6	10	16	40	20	15	50,2	53,4	63,6	201	95	237	10	M12	30
225	222,0 - 227,0	6	10	16	40	20	15	63,5	67,6	80,4	201	95	262	10	M12	30
250	247,0 - 253,0	6	10	16	40	20	15	78,4	83,4	99,3	201	95	287	10	M12	40
280	277,0 - 283,0	6	10	16	40	20	15	98,4	104,7	124,6	201	95	317	10	M12	40
315	311,0 - 317,0	6	10	40	20	124,5	132,5	201	95	352	10	M12	40			
355	351,0 - 357,0	6	10	40	20	158,1	168,3	201	95	392	10	M16	50			
400	396,0 - 402,0	6	10	40	15	200,8	192,0	201	95	437	10	M16	50			

E Permitted gaps PS Working pressure OD Outside Diameter ΔT Temperature differential Tor. Torque Value

OD	Maximum diameter difference	Maximum angular deflection	Maximum misalignment
mm	mm	degrees	mm
63	1,0	4,0	1,0
75 - 90	1,5	4,0	1,0
110 - 140	2,5	4,0	1,0
160 - 225	2,5	2,0	2,0
250 - 400	2,5	2,0	3,0

See page 7 (Permitted tolerances)