

# For PE and PVC pipe

## Serie FIX-U

For the correct operation of the coupling, fitting instructions must be respected.  
 Presión de prueba = 1,25 x PS

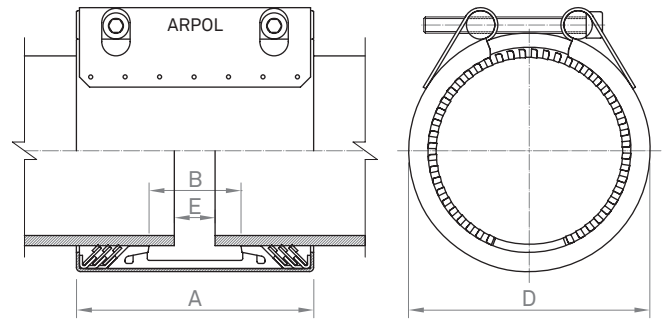

It is necessary to place an inner ring inside the PE or PVC pipe to stiffen it and prevent the deformation and reduction of pipe diameters caused by temperature differentials.

	Quality W1		Quality W2		Quality W4		Quality W5	
	AISI	DIN	AISI	DIN	AISI	DIN	AISI	DIN
Casing					304 L	1.4307	316 L	1.4404
Bolts					304	1.4301	316	1.4401
Bars					304 L	1.4307	316 L	1.4404
Inner Steel Bridge (Lock)					304 L	1.4307	316 L	1.4404
Widhring ring					302	1.4310	316 L	1.4404

Sealing gasket: EPDM / NBR / Silicone azul

OD	Range	Pressure		ΔT max.			Max axial load			Dimensions				Bolts		
				°C			kN			A in	B in	D in	E in	Diam.	Tor. lbf ft	
				PS6	PS10	PS16	PS6	PS10	PS16							
2.375	2.33 - 2.41	140	230	100	80	1,7	2,1	3,90	4,61	1,22	3,24	0,20	M8	10		
2.875	2.83 - 2.91	140	230	100	80	2,4	3,0	4,61	1,22	3,82	0,20	M8	10			
3.50	3.46 - 3.54	140	230	100	80	3,4	4,4	4,61	1,22	4,37	0,20	M8	15			
4.50	4.45 - 4.53	140	230	100	80	5,1	6,5	4,61	1,77	5,35	0,20	M8	15			
4.80	4.72 - 4.84	140	230	100	80	6,6	8,4	4,65	1,77	5,74	0,20	M10	15			
5.563	5.43 - 5.59	140	230	100	80	8,3	10,6	4,65	1,77	6,46	0,20	M10	15			
6.625	6.54 - 6.69	140	230	100	80	10,8	13,8	4,65	1,77	7,57	0,20	M10	15			
6.90	6.81 - 6.97	80	140	230	100	70	60	9,1	9,7	11,6	7,91	3,74	8,35	0,20	M12	25
8.625	8.54 - 8.70	80	140	230	100	70	60	14,3	15,2	18,1	7,91	3,74	10,08	0,40	M12	25
9.05	8.94 - 9.13	80	140	230	100	70	60	14,3	15,2	18,1	7,91	3,74	10,51	0,40	M12	25
10.75	10.63 - 10.83	80	140	230	100	70	60	22,1	23,5	28,0	7,91	3,74	12,20	0,40	M12	30
11.10	10.91 - 11.14	80	140	230	100	70	60	22,1	23,5	28,0	7,91	3,74	12,48	0,40	M12	30
12.75	12.60 - 12.83	80	140	230	100	70	60	28,0	29,8	35,5	7,91	3,74	14,17	0,40	M12	30
13.20	13.07 - 13.31	80	140	230	100	70	60	28,0	29,8	35,5	7,91	3,74	14,65	0,40	M12	30
14.00	13.82 - 14.06	80	140	230	100	70	60	35,5	37,8	45,1	7,91	3,74	15,43	0,40	M16	40
15.30	15.16 - 15.39	80	140	230	100	60	60	45,1	43,2	51,1	7,91	3,74	16,73	0,40	M16	40
16.00	15.83 - 16.06	80	140	230	100	60	60	45,1	43,2	51,1	7,91	3,74	17,44	0,40	M16	40

E Permitted gaps PS Working pressure OD Outside Diameter ΔT Temperature differential Tor. Torque Value

OD	Maximum diameter difference	Maximum angular deflection	Maximum misalignment
in	mil	degrees	mil
63	1,0	4,0	1,0
75 - 90	1,5	4,0	1,0
110 - 140	2,5	4,0	1,0
160 - 225	2,5	2,0	2,0
250 - 400	2,5	2,0	3,0

See page 5 (Permitted tolerances)